

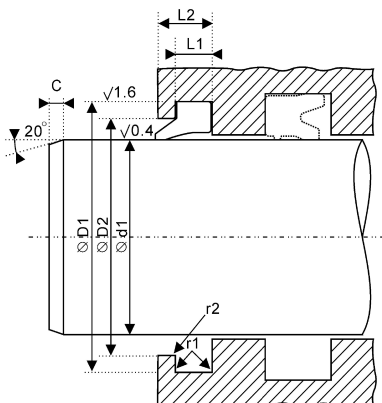

装配例



型式例

截面图	材料	温度范围	速度	特点	代号
	NBR	-30至100	2	适用范围广, 安装便捷	F1
	FKM	-20至200			
	PU	-35至100			

d1	D1	L1	d1	D1	L1	d1	D1	L1	d1	D1	L1	d1	D1	L1
1/4	1/2	1/8	1-15/16	2-5/16	3/16	4-7/8	5-5/8	3/8	12	13	1/2	6	6-3/4	3/8
3/8	5/8	1/8	2	2-1/2	1/4	5	5-3/4	3/8	12	13-1/4	1/2	7	7-3/4	3/8
7/16	11/16	1/8	2	2-1/2	1/4	5	5-1/2	1/4	12-1/2	13-1/2	1/2	7-1/4	8	3/8
1/2	3/4	1/8	2-1/8	2-5/8	1/4	5-1/4	6	3/8	底座开槽			9	9-3/4	3/8
9/16	13/16	1/8	2-1/8	2-1/2	3/16	5-1/2	6-1/4	3/8	1/2	3/4	1/8			
5/8	7/8	1/8	2-1/4	2-3/4	1/4	5-3/4	6-1/2	3/8	5/8	7/8	1/8			
5/8	7/8	1/8	2-3/8	2-7/8	1/4	6	6-3/4	3/8	3/4	1-1/8	3/16			
3/4	1-1/8	3/16	2-1/2	3	1/4	6-1/4	7	3/8	7/8	1-1/4	3/16			
13/16	1-3/16	3/16	2-1/2	3	1/4	6-1/2	7-1/4	3/8	1	1-3/8	3/16			
7/8	1-1/4	3/16	2-5/8	3-1/8	1/4	6-1/2	7-1/2	3/8	1-1/8	1-1/2	3/16			
15/16	1-5/16	3/16	2-3/4	3-1/4	1/4	6-1/2	7-1/2	1/2	1-1/4	1-5/8	3/16			
1	1-3/8	3/16	2-7/8	3-3/8	1/4	6-3/4	7-1/2	3/8	1-3/8	1-3/4	3/16			
1	1-3/8	3/16	3	3-1/2	1/4	7	7-3/4	3/8	1-1/2	1-7/8	3/16			
1.1	1.49	3/16	3	3-1/2	1/4	7	8	1/2	1-3/4	2-1/8	3/16			
1-1/8	1-1/2	3/16	3-1/8	3-5/8	1/4	7	8	0.4	2	2-1/2	1/4			
1-1/8	1-1/2	3/16	3-1/4	3-3/4	1/4	7-1/2	8-1/4	3/8	2-1/8	2-5/8	1/4			
1-3/16	1-9/16	3/16	3-1/4	3-3/4	1/4	7-1/2	8-1/2	3/8	2-1/4	2-3/4	1/4			
1-1/4	1-5/8	3/16	3-3/8	3-7/8	1/4	7-3/4	8-1/2	3/8	2-1/2	3	1/4			
1-1/4	1-5/8	3/16	3-1/2	4	1/4	8	8-3/4	3/8	2-5/8	3-1/8	1/4			
1-5/16	1-11/16	3/16	3-1/2	4	1/4	8	8-1/2	1/4	2-3/4	3-1/4	1/4			
1-3/8	1-3/4	3/16	3-5/8	4-1/8	1/4	8-1/4	9	3/8	3	3-1/2	1/4			
1-3/8	1-3/4	3/16	3-3/4	4-1/4	1/4	8-1/2	9-1/4	3/8	3-1/8	3-5/8	1/4			
1-7/16	1-13/16	3/16	3-7/8	4-3/8	1/4	8-1/2	9	1/4	3-1/4	3-3/4	1/4			
1-1/2	1-7/8	3/16	4	4-1/2	1/4	8-3/4	9-1/2	3/8	3-1/2	4	1/4			
1-1/2	1-7/8	3/16	4-1/8	4-5/8	1/4	9	9-3/4	3/8	4	4-1/2	1/4			
1-9/16	1-15/16	3/16	4-1/4	4-3/4	1/4	9-1/2	10-1/4	3/8	4-1/4	4-3/4	1/4			
1-5/8	2	3/16	4-3/8	4-7/8	1/4	9-3/4	10-1/2	3/8	4-1/2	5-1/4	3/8			
1-3/4	2-1/8	3/16	4-1/2	5-1/4	3/8	10	11	1/2	4-3/4	5-1/2	3/8			
1-3/4	2-1/8	3/16	4-1/2	5	1/4	10	10-1/2	1/4	5	5-3/4	3/8			
1-7/8	2-1/4	3/16	4-3/4	5-1/2	3/8	11	12	1/2	5-1/4	6	3/8			

普通防尘圈 F1



d1	D1	L1	d1	D1	L1	d1	D1	L1	d1	D1	L1	d1	D1	L1
1/2	0.76	.104	1-1/2	1.802	0.104	4-1/4	4.677	0.135	内侧凸台型					
1/2	0.76	.104	1-5/8	1.927	0.104	4-3/8	4.802	0.135	3/4	1-1/8	3/16			
9/16	0.823	.104	1-5/8	1.927	0.104	4-1/2	4.927	0.135	1	1-3/8	3/16			
5/8	0.885	.104	1-3/4	2.052	0.104	4-1/2	4.927	0.135	1-1/8	1-1/2	3/16			
5/8	0.885	.104	1-3/4	2.052	0.104	4-5/8	5.052	0.135	1-1/4	1-5/8	3/16			
11/16	0.948	.104	1-7/8	2.177	0.104	4-3/4	5.177	0.135	1-3/8	1-3/4	3/16			
3/4	1.01	.104	2	2.302	0.104	4-7/8	5.302	0.135	1-1/2	1-7/8	3/16			
3/4	1.01	.104	2	2.302	0.104	5	5.427	0.135	1-3/4	2-1/8	3/16			
3/4	1.01	.104	2	2.302	0.104	5	5.427	0.135	1-5/8	2	3/16			
3/4	1.01	.104	2-1/8	2.427	0.104	5-1/8	5.552	0.135	2	2-1/2	1/4			
13/16	1.084	.104	2-1/8	2.427	0.104	5-1/4	5.677	0.135	2-1/4	2-3/4	1/4			
13/16	1.084	.104	2-1/4	2.552	0.104	5-3/8	5.802	0.135	2-1/2	3	1/4			
7/8	1.147	.104	2-1/4	2.552	0.104	5-1/2	5.927	0.135	3	3-1/2	1/4			
7/8	1.118	.104	2-1/4	2.552	0.104	5-5/8	6.114	0.151	3-1/4	3-3/4	1/4			
7/8	1.118	.104	2-3/8	2.677	0.104	5-3/4	6.239	0.151	3-1/2	4	1/4			
7/8	1.147	.104	2-1/2	2.802	0.104	5-7/8	6.364	0.151	4	4-1/2	1/4			
15/16	1.209	.104	2-1/2	2.802	0.104	6	6.489	0.151	4-1/2	5-1/4	3/8			
1	1.272	.104	2.498	2.802	0.104	6-1/4	6.739	0.151	5	5-3/4	3/8			
1	1.272	.104	2-5/8	2.989	0.119	6-1/2	6.989	0.151	5-1/4	6	3/8			
1	1.272	.104	2-3/4	3.114	0.119	6-3/4	7.239	0.151	5-1/2	6-1/4	3/8			
1	1.272	.104	2-3/4	3.114	0.119	7	7.484	0.151	6	6-3/4	3/8			
1-1/16	1.334	.104	2-7/8	3.239	0.119	7-1/4	7.739	.151						
1-1/8	1.397	.104	3	3.364	0.119	7-1/2	7.989	.151						
1-1/8	1.397	.104	3	3.364	0.119	7-3/4	8.247	0.151						
1-3/16	1.459	.104	3-1/8	3.489	0.119	8	8.484	0.151						
1-1/4	1.522	.104	3-1/4	3.614	0.119	8-1/2	8.989	0.151						
1-1/4	1.49	.104	3-1/4	3.614	0.119	9	9.497	0.151						
1-1/4	1.522	.104	3-3/8	3.729	0.119	9-1/2	9.989	0.151						
1-1/4	1.522	.104	3-1/2	3.864	0.119	10	10.497	0.151						
1-5/16	1.614	.104	3-1/2	3.864	0.119	10-1/2	10.997	0.151						
1-3/8	1.677	.104	3-5/8	3.989	0.119	11	11.497	0.151						
1-3/8	1.677	.104	3-3/4	4.114	0.119	9-1/4	9.739	0.135						
1-3/8	1.677	.104	3-7/8	4.239	0.119									
1-7/16	1.739	.104	4	4.427	0.135									
1-1/2	1.802	.104	4	4.427	0.135									
1-1/2	1.738	.104	4	4.427	0.135									
1-1/2	1.802	.104	4-1/8	4.552	0.135									